

VRLA - Sealed Maintenance-Free

XMB 12-45X 12V/45AH (20h)

VRLA-AGM BATTERIES

Las baterías XMB conforman una familia de baterías de ácido plomo tipo VRLA de descarga profunda de excelente calidad, rendimiento extraordinario y un amplio rango de aplicaciones. Han sido diseñadas para cumplir con los más exigentes estándares mundiales de calidad, seguridad y rendimiento, usando tecnología punta. Son 100% libres de mantenimiento y selladas para una operación sin fugas. Usan tecnología AGM para una eficiente recombinación de gases hasta de 99%.

APLICACIONES PRINCIPALES

Telecom



Sistemas de Seguridad



Luminaria de Emergencia

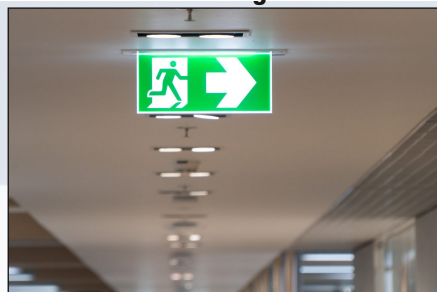

Respaldo de Sistemas Críticos



UPS/SAI

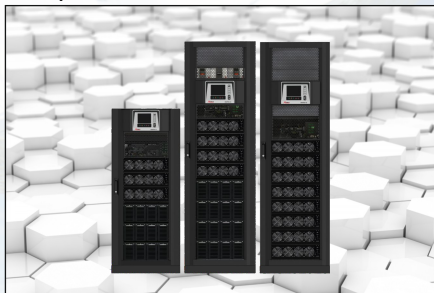

Inversores AC/DC



CARACTERÍSTICAS

- Baterías selladas de libre mantenimiento
- Separadores AGM y placas planas
- Opciones en terminales de conexión
- Caja de ABS de alto impacto
- Recarga rápida
- Auto descarga inferior al 3.5%/mes

VENTAJAS

- Temperatura de operación: -15 to +50°C
- Tiempo de vida: 5 a 8 años (@ 20°C)
- Tiempo de vida en cantidad de ciclos:
 - > 1500 ciclos a 30% DOD
 - > 600 ciclos a 50% DOD
 - > 300 ciclos a 100% DOD
- Alto rendimiento a bajas temperaturas

VRLA - SEALED MAINTENANCE-FREE BATTERY

12V/45AH (20h)

Xmart
by **Integra**

TECHNICAL SPECIFICATIONS / Especificaciones Técnicas

Nominal Voltage	12V	
Nominal Capacity (10hr)	45.0AH	
Dimension	Length	198 +/- 2mm
	Width	166 +/- 2mm
	Container Height	169 +/- 2mm
	Total Height (with terminals)	169 +/- 2mm
Approx Weight	Approx. 13.8 Kg	
Terminal	F4(M6) / F11(M6)	
Container Material	ABS	
Rated Capacity	45.0 AH / 4.50A	(10hr, 1.80V/cell, 25°C/77°F)
	39.3 AH / 7.83A	(5hr, 1.75V/cell, 25°C/77°F)
	34.8 AH / 11.3A	(3hr, 1.60V/cell, 25°C/77°F)
Max. Discharge Current	450A (5s)	
Internal Resistance	Approx. 9 mili Ohm	
Operating Temperature Range	Discharge:	-20°C to 60°C (-4 to 140°F)
	Charge:	0°C to 50°C (32 to 122°F)
	Storage:	-20°C to 60°C (-4 to 140°F)
Normal Operating Temp. Range	25°C +/- 5°C (77°F +/- 5°F)	
Cycle Use	Initial Charging Current less than 30.0 A. Voltage 14.6V - 14.8V at 25°C. Temp coefficient -4mV/°C/Cell	
Standby Use	No limit on initial charging current voltage 13.6V - 13.8V at 25°C (77°F) Temp. coefficient -3mV/°C/Cell	
Capacity affected by Temperature	40°C (104°F)	103%
	25°C (77°F)	100%
	0°C (32°F)	86%



APPLICATIONS / Aplicaciones

UPS
Inversores AC/DC
Luminaria de emergencia
Sistemas de comunicación
Fuentes DC
Equipos electrónicos
Sistemas de respaldo en general

TERMINAL F11 / Terminal F11

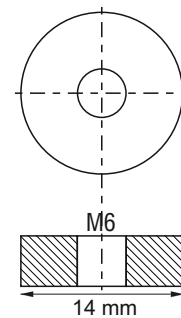

DIMENSIONS / Dimensiones

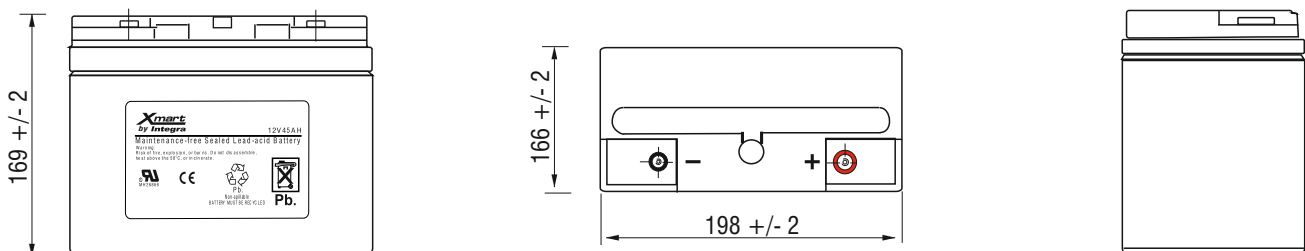

* VRLA: Valve Regulated Lead Acid / * AGM: Absorbent Glass Material

12-45AH: P2

VRLA - SEALED MAINTENANCE-FREE BATTERY

12V - 45AH (20h)



CONSTANT DISCHARGE / Descarga Constante (Amps at 25°C)

F.V/Time	5min	10min	15min	30min	1h	2h	3h	4h	5h	8h	10h	20h
1.85V	99.0	64.7	53.3	35.6	21.3	13.1	10.4	8.31	7.13	5.05	4.24	2.24
1.80V	112.5	79.2	64.2	41.3	23.8	14.3	11.3	8.94	7.65	5.38	4.50	2.36
1.75V	123.5	87.5	69.5	43.2	24.7	14.8	11.6	9.20	7.85	5.48	4.56	2.38
1.70V	132.2	95.5	74.7	45.2	25.7	15.3	12.0	9.44	8.05	5.55	4.62	2.41
1.65V	139.0	103.8	79.8	47.3	26.6	15.9	12.3	9.71	8.27	5.64	4.69	2.44
1.60V	144.2	109.8	83.4	49.3	27.5	16.4	12.7	9.98	8.49	5.71	4.75	2.48

CONSTANT DISCHARGE / Descarga Constante (Watts/Cell at 25°C)

F.V/Time	5min	10min	15min	30min	1h	2h	3h	4h	5h	8h	10h	20h
1.85V	186.5	120.3	100.1	68.0	41.3	25.4	20.3	16.2	14.0	9.98	8.38	4.44
1.80V	208.2	144.7	118.9	78.1	45.8	27.6	21.9	17.4	15.0	10.6	8.89	4.67
1.75V	224.6	157.1	127.0	80.9	47.4	28.5	22.5	17.9	15.3	10.8	9.00	4.71
1.70V	236.1	168.6	134.5	83.8	48.9	29.4	23.1	18.3	15.6	10.9	9.10	4.77
1.65V	245.5	179.8	141.5	86.8	50.2	30.2	23.6	18.7	16.0	11.0	9.23	4.82
1.60V	248.1	186.7	145.9	89.5	51.7	31.0	24.2	19.2	16.4	11.1	9.33	4.89

DISCHARGE CURVES / Curvas de Descarga

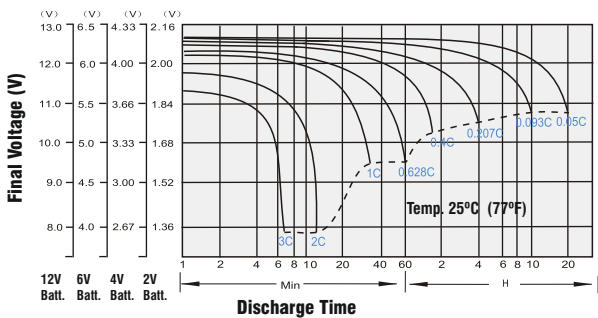

RECHARGING / Recarga

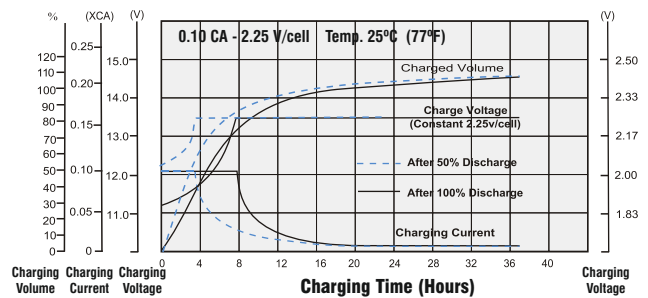

CAPACITY Vs. TEMP. / Capacidad Vs. Temp.

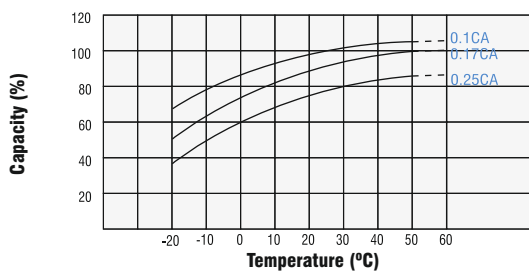

LIFE EXPECTANCY Vs. TEMP. / Vida Vs. Temp.

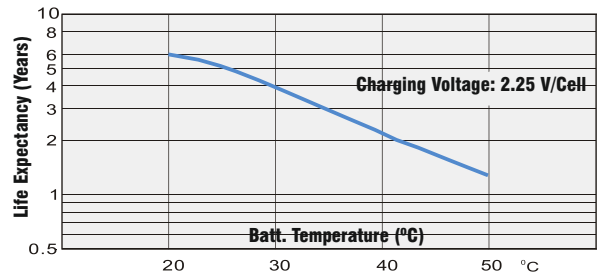

DISCHARGING CYCLES / Vida Vs. Descargas

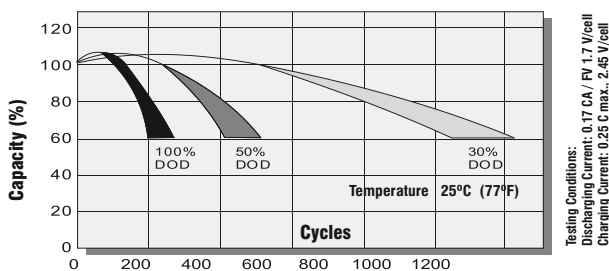

Testing Conditions:
Discharging Current: 0.17 CA / FV 1.7 V/cell
Charging Current: 0.25 C max., 2.45 V/cell

STORAGE TIME / Tiempo de Almacenaje

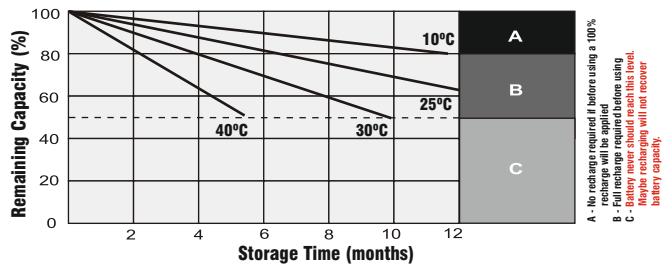

A - No recharge required if battery using at 100%
B - Full recharge required before using
C - Battery never should reach this level. Maybe recharging will not recover battery capacity.